

PIN:A1869

# X - blower >>>

2 Channel VR Fan Kit

Application :

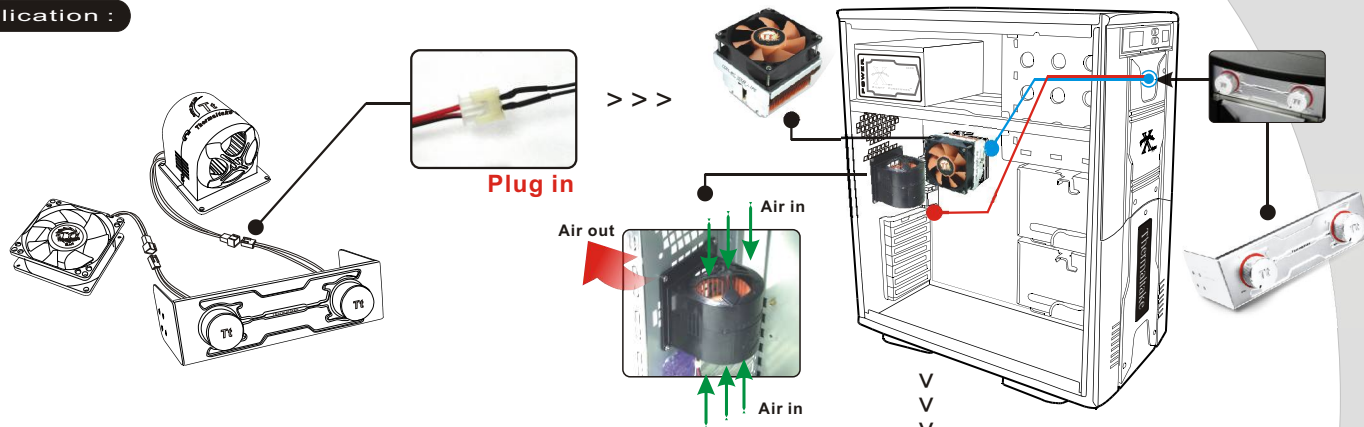

Smart Case Fan II (3 functions) :

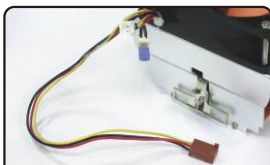

Function 1

Full speed 4800 rpm :  
Leave the jumper on.

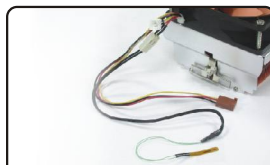

Function 2

Temp. auto control  
1300rpm at 20°C ~  
4800rpm at 55°C :  
Remove the jumper.  
Attach the temperature  
sensor to anywhere on  
the computer with the  
thermal adhesive.

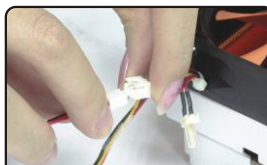

Function 3

Adjustable manual fan  
speed control from 1300  
rpm to 4800 rpm :  
Remove the jumper.  
Plug in the fan speed  
control panel as shown.

Recommended application :

- 80x80x70mm Blower for Case fan
- 80x80x25mm Axial flow fan for CPU cooling fan
- These two fans are exchangeable by supplied screws.
- **Note:** There are 3 packages of screws included
  - A : For Axial fan
  - B : For Blower fan
  - C : For fan speed control panel